

FOR LEASE - OFFICE SUITE

3 CORPORATE DRIVE

HALFMOON
NEW YORK 12065



PROPERTY DETAILS

FEATURES

Offered for lease are two, $\pm 3,716$ SF and $\pm 3,513$ SF Class A office suites in Halfmoon, NY

LOCATION

Route 9 to Corporate Drive, building on right side

UTILITIES

Municipal Water and Sewer

ZONING

Planned Development District & Overlay District

PRICE

For Lease at \$14.50 NNN

(NNN est. = \$5.48/RSF)

ADDITIONAL INFORMATION

Tax ID#: 278.-1-22.171

- + $\pm 7,229$ SF RSF suite that can be leased separately as a $\pm 3,716$ and/or $\pm 3,513$ RSF suite
- + A total of $\pm 10,024$ contiguous RSF is available, as is an additional 2,695 RSF suite across the hall
- + See floor plan on back for options; Contact broker for additional information



CONTACT INFORMATION

LAURIE TYLEND, SIOR, CCIM

Associate Broker

+1 518 452 2700 x139

Laurie.Tylenda@cbre-albany.com

Preliminary

www.cbre.us/Albany

CBRE | Albany

Part of the CBRE affiliate network

FOR LEASE 3 CORPORATE DRIVE

HALFMOON, NY 12065

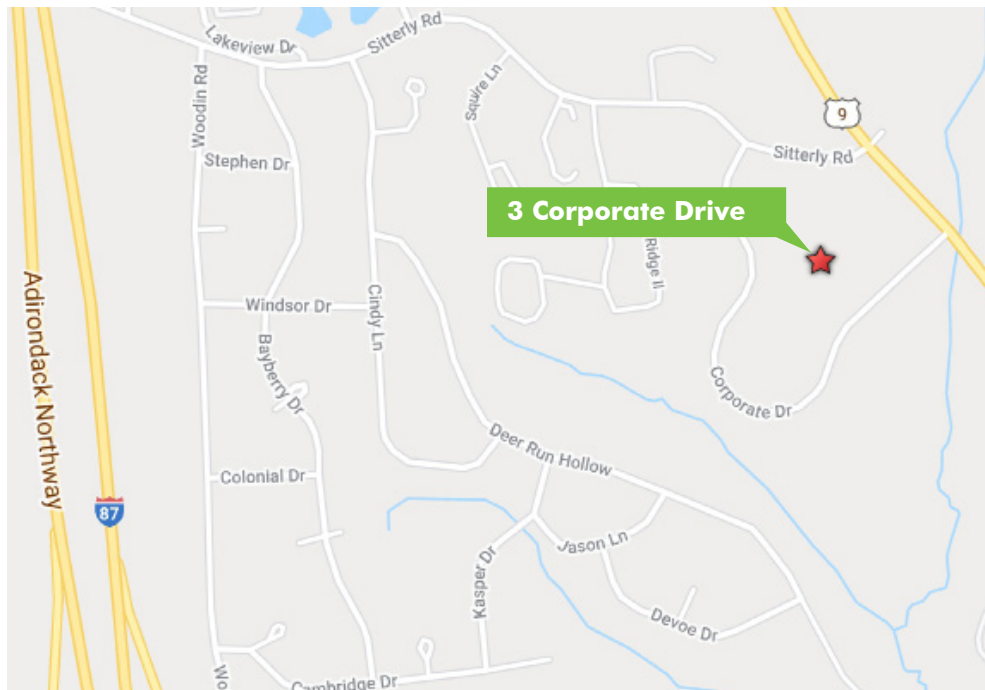
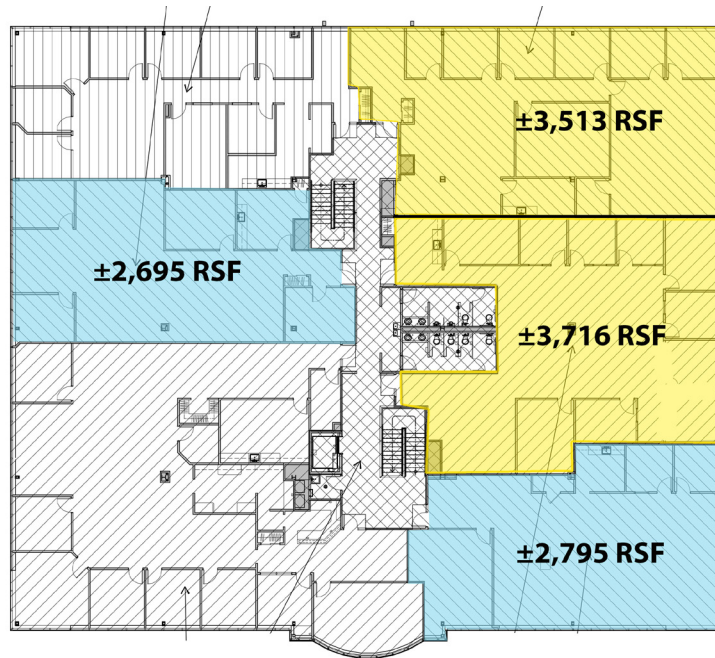

© 2020 CBRE-Albany This information has been obtained from sources believed reliable. We have not verified it and make no guarantee, warranty or representation about it. Any projections, opinions, assumptions or estimates used are for example only and do not represent the current or future performance of the property. You and your advisors should conduct a careful, independent investigation of the property to determine to your satisfaction the suitability of the property for your needs. Photos herein are the property of their respective owners and use of these images without the express written consent of the owner is prohibited.

210 WASHINGTON AVENUE EXTENSION, SUITE 201 | ALBANY, NY 12203

www.cbre-AlbanyProperties.com

CBRE Albany

Part of the CBRE affiliate network